



# Coimisiún na Scrúduithe Stáit

## State Examinations Commission

*Junior Certificate Examination, 2017*

# *Technical Graphics*

## *Ordinary Level*

### *Section A*

*(120 marks)*

*Monday, 19 June*  
*Morning 9:30 - 12:00*

<b>Centre Number</b>

### **Instructions**

- (a) Answer **any ten** questions in the spaces provided.  
All questions carry equal marks.
- (b) Construction lines must be clearly shown.
- (c) All measurements are in millimetres.
- (d) This booklet must be handed up at the end of the examination.
- (e) Write your examination number in the box provided below  
and on all other pages used.

**Examination Number:**

--

<b>Centre Number</b>

Question	Mark
Section A	
1	
2	
3	
4	
5	
6	
<b>TOTAL</b>	
<b>GRADE</b>	

**SECTION A.** Answer **any ten** questions. All questions carry equal marks.

- 1.** Shown is the elevation and **incomplete** end view of a computer printer. Also shown is a 3D graphic of the printer.

**Insert** the missing lines in the end view.

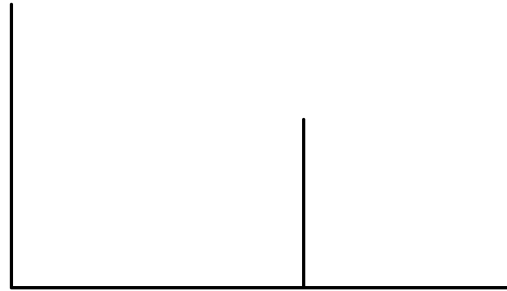
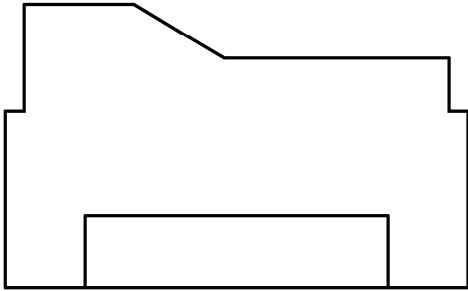
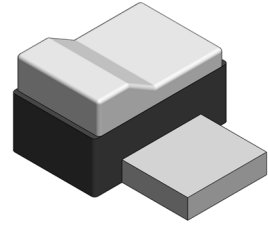

- 2.** In the space provided, make a **freehand pictorial sketch** of the sports cone shown below.

Colour **or** shade the completed sketch.

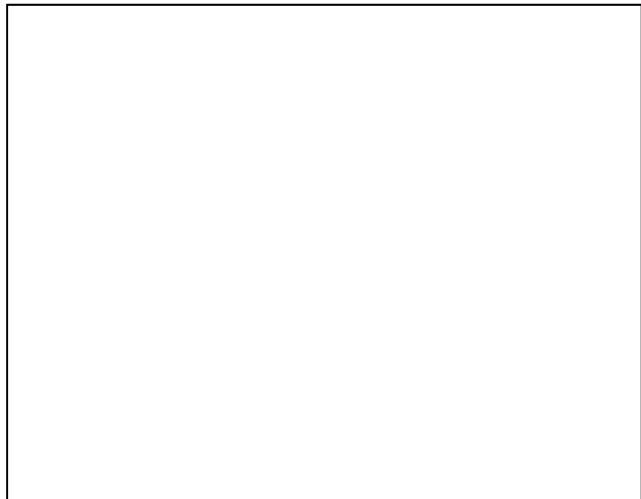
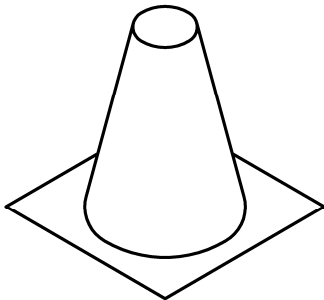

- 3.** Name the computer related items **A** and **B** shown below.



**A** \_\_\_\_\_



**B** \_\_\_\_\_

Give **one** advantage of item **A** over item **B**.

---

---

4. Fig. 1 shows a logo for a car clamping company inscribed in the square ABCD.

Draw the enlarged logo in the given square ABCD in Fig. 2.

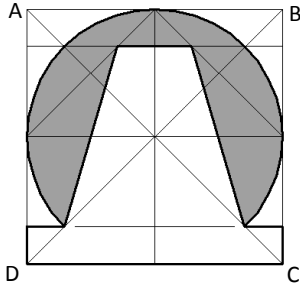

Fig. 1

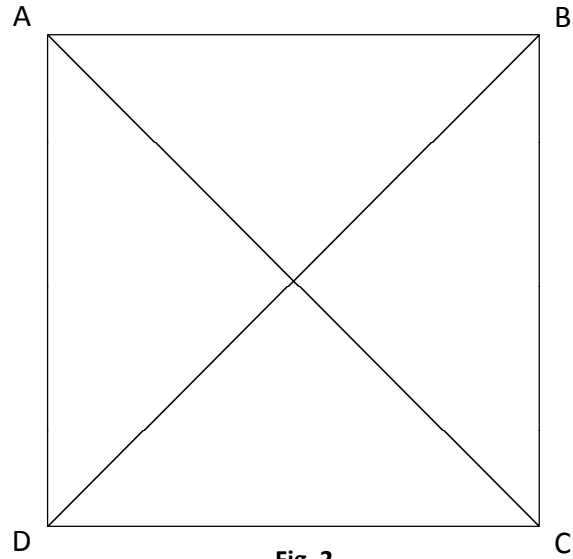

Fig. 2

5. Fig. 1 shows the outline of a chef's hat based on an ellipse and a rectangle.

$F_1$  and  $F_2$  are the focal points of the ellipse. Locate the focal points in Fig. 2 and complete the outline by drawing the rectangle ABCD as shown.

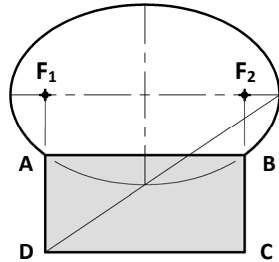

Fig. 1

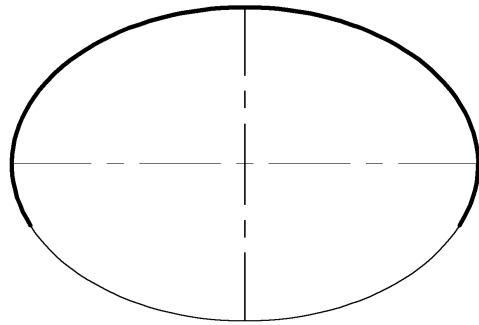
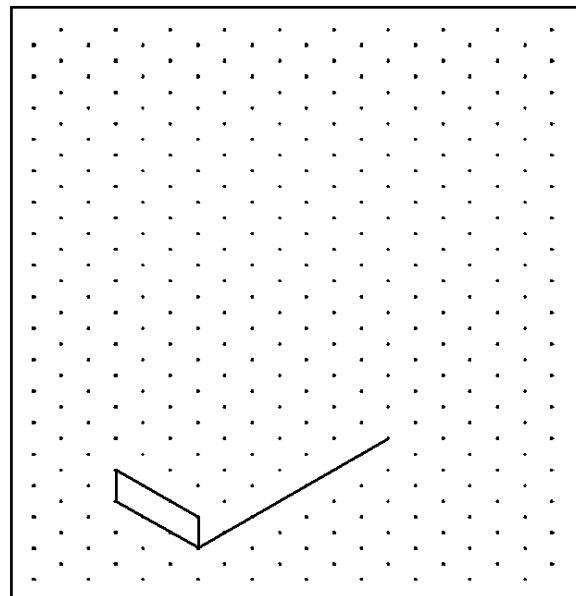
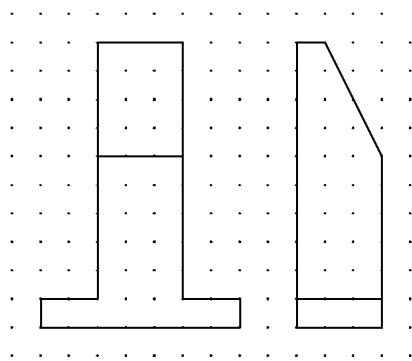

Fig. 2

6. The elevation and end view of an electric car charging point are shown. Make a well proportioned **freehand sketch** of the charging point in the space provided. Colour or shade the completed sketch.



7. The outline of a label for a bottle is shown. Also shown is a 3D graphic of the label on the bottle.

Write down the area of the label in square units.

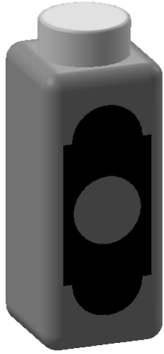

1 square = 1 square unit.

Area of the label = \_\_\_\_\_ square units.

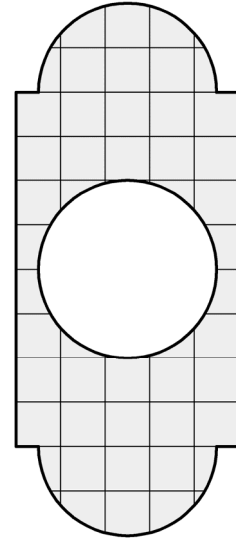

8. Using the scale provided, **measure** and **write down** the dimensions **A** and **B** for the basketball stand shown.

A: \_\_\_\_\_

B: \_\_\_\_\_

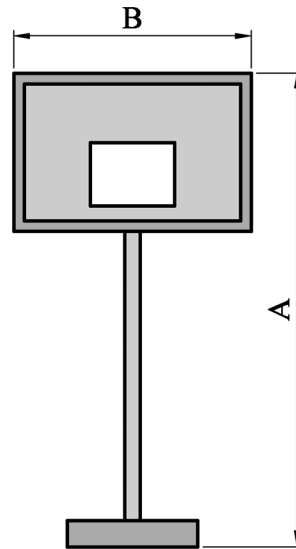
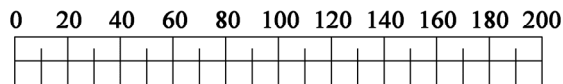

9. Fig.1 shows a set of blocks.

Choose the correct elevation for Fig.1 from the options shown in Fig.2 below.

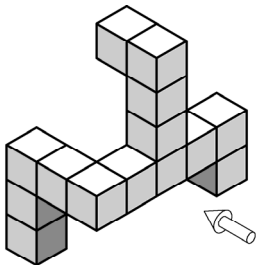
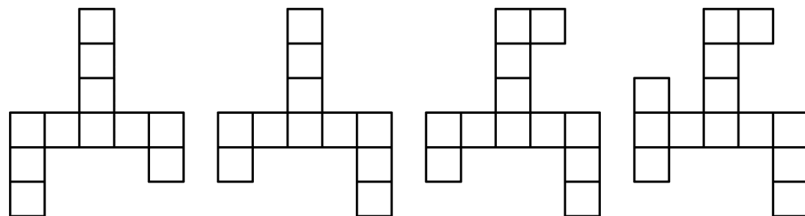

Fig. 1



A

B

C

D

Fig. 2

Answer: \_\_\_\_\_

- 10.** The figure shows the incomplete outline of a golf club. Also shown is a 3D graphic of the club.

Complete the drawing of the golf club by constructing a tangent from point **P** to the circle **C**.

Show all construction and the point of contact.

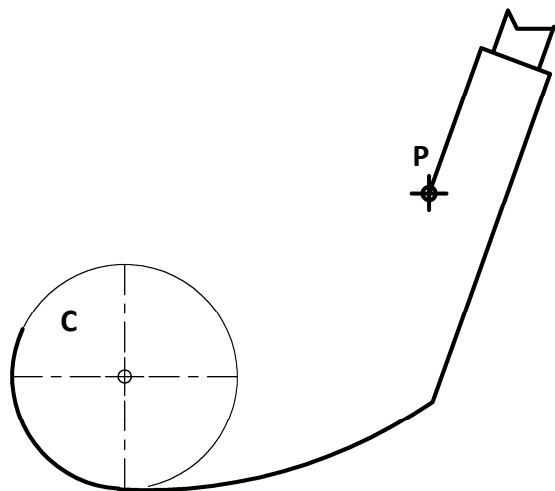

- 11.** Write down **any two** CAD commands used to create the drawing of the try-square.

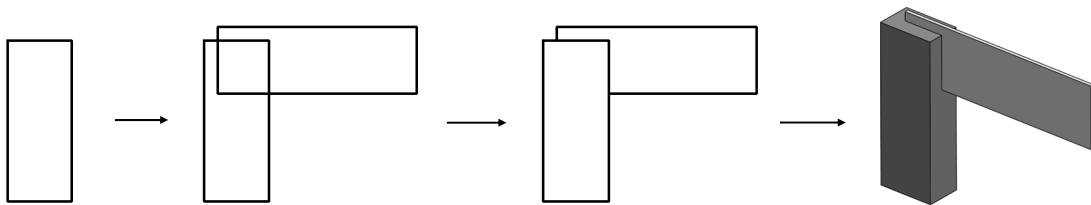

Any **two** CAD commands: \_\_\_\_\_  
 \_\_\_\_\_

- 12.** Twelve students were surveyed about the type of music that they listened to.

**Shade** the pie chart to represent the following results from the survey.

- Pop - 6 students
- Rock - 4 students
- R & B - 2 students

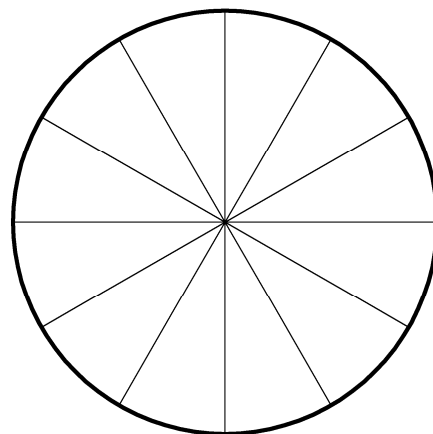

- 13.** Fig. 1 shows a design for a windfarm logo. The design is based on a regular hexagon and arcs as shown.

Fig. 2 shows an **incomplete** drawing of the design. Complete the drawing showing all constructions.

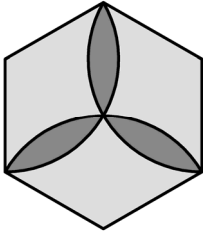

Fig. 1

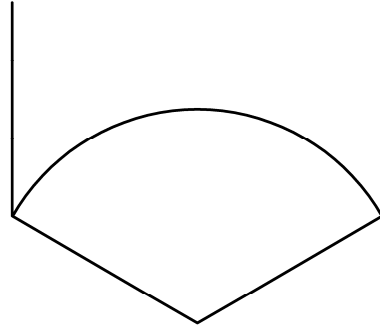
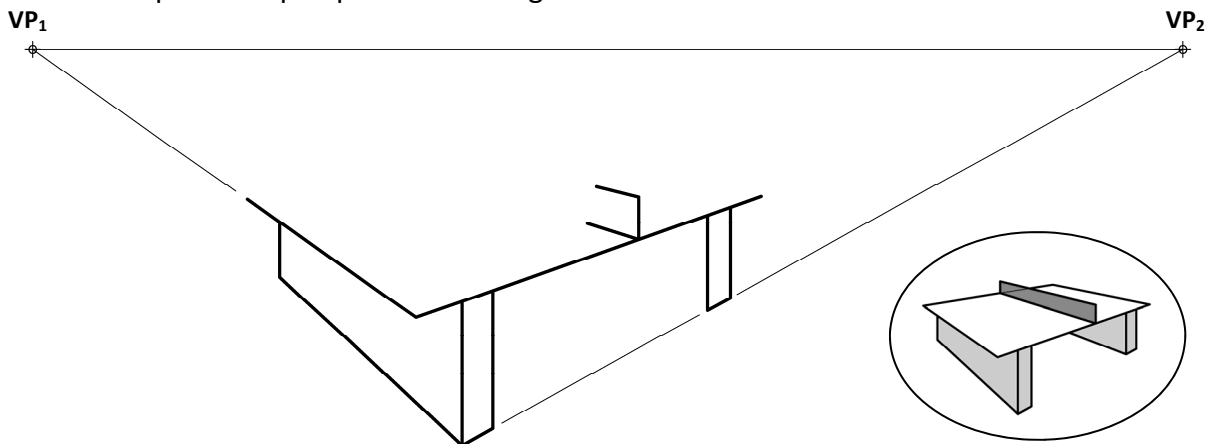

Fig. 2

- 14.** The figure shows an **incomplete** two point perspective drawing of a table-tennis table. A 3D graphic of the table is also shown.

Complete the perspective drawing of the table.



- 15.** Fig. 1 shows a logo for a badminton club.

Complete the design of the logo in Fig. 2 by constructing an axial symmetry in the line  $LL_1$ .

Colour **or** shade the completed logo.

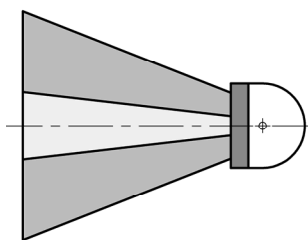

Fig. 1

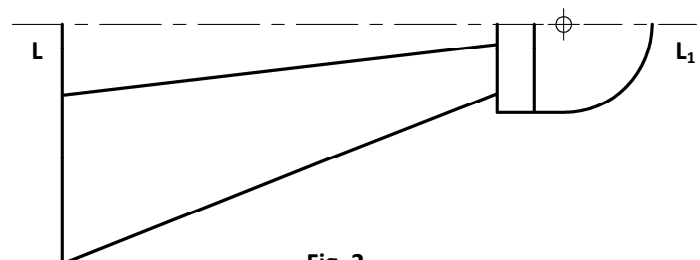

Fig. 2

**Blank Page**

**Blank Page**